

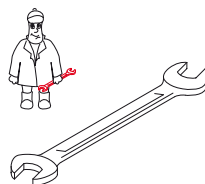

Gebr. Becker GmbH
Hölker Feld 29-31
D-42279 Wuppertal

Wartung
Maintenance
Entretien
Manutenzione
Mantenimiento



	Pos.	Menge Quantity Quantité Quantità Cantidad	Bestell-Nr. Ident No. No. Identification No. Identificazione No. de pedido	Bezeichnung Description Designation Designazione Descripción
U 4.40	...	1	549000 40500	Dichtungssatz, Complete set of seals, Jeu de joints, Kit di guarnizioni, Junta completa
	7	SATZ (KIT)	900585 00003	Schieber, Vane, Palette, Palette, Empujador
	58	1	965414 00000	Luftentölelement, Oil separating element, Element separation huile, Cartuccia separatore olio, Elemento de desaceitar de aire



Ersatzteilliste
Spare parts list
Liste de pièces de rechange
Listino pezzi di ricambio
Lista de piezas de recambio
Lista de peças sobresselentes
Reserveonderdelenlijst
Reservedelsliste
Reservdelslista

Reservedelsliste
Varaosaluettelo
Wykaz części zamiennych
Seznam náhradních dílů
Tartalékalkatrész lista
Κατάλογος ανταλλακτικών
Перечень запасных частей
备用零件目录
スペアパーツリスト

U 4.40

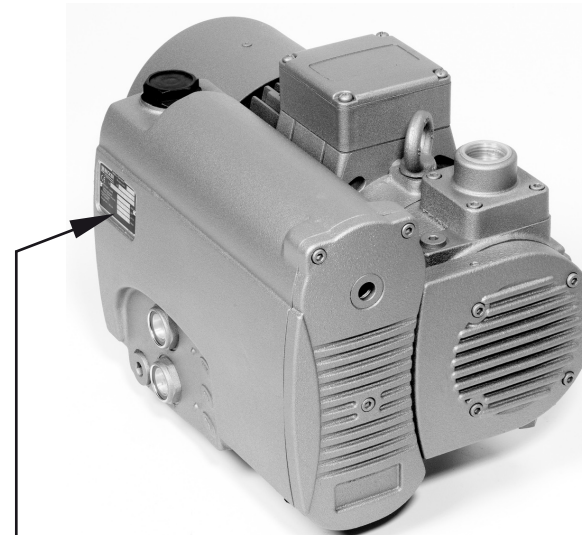

28000040500 03/2008

SERVICE

BECKER
D-42279 Wuppertal
www.becker-international.com

year

No.

type ← Option

frequency Hz

speed min⁻¹

power required kW

inlet capacity m³/h

max. vacuum mbar

Made in Germany

(D) Service:

Tel: +49 (0)202 697-171

Fax: +49 (0)202 64 44 74

E-Mail: info@becker-international.com

www.becker-international.com

Index	Pos.	Bestell Nr.	Beschreibung 
U 4.40	...	549000 40500	DICHTUNGSSATZ ¹⁾
	4	500101 40500	GEHÄUSE, KOMPL.
	6	020000 40500	KOLBEN
	7	900585 00003	SCHIEBER (SATZ)
	8	000700 40500	SEITENDECKEL
	9	945618 00000	GEWINDESTIFT
	14	945373 00000	INNENSECHSKANTSCHRAUBE
	15	945374 00000	INNENSECHSKANTSCHRAUBE
	16	947628 01000	ZYLINDERSTIFT
	17	945801 01000	GEWINDESTIFT
	18	901807 00000	WELLENENDSCHRAUBE
	19	949203 00000	ZAHNSCHEIBE
	20	016800 05000	SPANNSCHEIBE
	21	537500 10700	VENTIL, KOMPL.
	28	946917 00000	STIFTSCHRAUBE
	29	917107 00000	TELLERFEDER
	30	947105 00000	SECHSKANTMUTTER
	32	951228 02000	VERSCHLUSS-SCHRAUBE
	36	068101 40500	ZWISCHENSTÜCK
	37	945634 00000	GEWINDESTIFT
	38	741310 60000	GUMMIPUFFER
	44	867800 99559	SCHWIMMER
	45	005001 40300	SIEB
	47	727503 99628	ABBLASEVENTIL
	58	965414 00000	LUFTENTÖLELEMENT (1x) ²⁾
	59	016802 40300	SPANNSCHEIBE
	60	921500 50000	HANDGRIF
	63	003700 40500	DECKEL
66	945320 00000	INNENSECHSKANTSCHRAUBE	
67	953103 00000	DÜSE	
72	005000 40500	SIEB	
74	945321 00000	INNENSECHSKANTSCHRAUBE	
82	960200 40500	KÜHLER	
83	917800 40500	HALTERRING	
84	960700 40500	LÜFTERHAUBE	
85	946308 00000	ZYLINDERSCHRAUBE	
86	948750 00000	BLINDNIET	
89	912317 00000	ANSCHLUSS-SCHRAUBE	
90	948407 00000	HOHLSCHRAUBE	
94	012203 40500	LEITUNG	
95	012204 40500	LEITUNG	
97	068100 40300	STÜTZE	
98	741310 80000	GUMMIPUFFER	
99	945218 00000	SECHSKANTSCHRAUBE	
101	002401 40500	ÖLABSCHEIDERGEHÄUSE	
103	907309 00000	ÖLSCHAUGLAS	
105	951219 00000	VERSCHLUSS-SCHRAUBE	
107	951221 00000	VERSCHLUSS-SCHRAUBE	

Index	Pos.	Bestell Nr.	Beschreibung 
U 4.40	110	916800 10000	SCHRAUBDECKEL
	114	912318 00000	ANSCHLUSS-SCHRAUBE
	115	003300 10700	DÜSE
	116	912300 00000	ANSCHLUSS-SCHRAUBE
	118	009400 19000	KUGELSTÜCKSCHRAUBE
	119	012200 40300	LEITUNG
	197	741103 99682	NIVEAUGEBER - OPTIONAL
	201	007801 40500	GEWINDEFLANSCH - STANDARD
	202	007802 40500	GEWINDEFLANSCH 90° - OPTIONAL
	203	537506 99633	RÜCKSCHLAGVENTIL
	205	947701 00000	PASSFEDER

¹⁾ Dichtungssatz - 549000 40500

- Pos.: 11, 12, 25, 26, 33, 42, 55, 62, 65, 73, 91, 104, 106, 108, 117, 147, 208

²⁾ erforderliche Bestellmenge / Wartung

OPTIONAL	U4.40	/09	Sonderausführung - mit Gasballastventil
		/0-25	Sonderausführung - mit Öl-Wasser-Kühler
		/0-56	
<div style="border: 1px solid black; padding: 5px; display: inline-block;"> Abweichende Positionen zum Standardgerät - siehe Anhang (Zeichnungsrückseite) </div> 			

Index	Pos.	Ident No.	Description 
U 4.40	...	549000 40500	SET OF SEALS ¹⁾
	4	500101 40500	PUMP BODY
	6	020000 40500	ROTOR
	7	900585 00003	VANES (KIT)
	8	000700 40500	LID
	9	945618 00000	THREADED PIN
	14	945373 00000	SOCKET HEAD SCREW
	15	945374 00000	SOCKET HEAD SCREW
	16	947628 01000	STRAIGHT PIN
	17	945801 01000	THREADED PIN
	18	901807 00000	SCREW
	19	949203 00000	TOOTHED SPRING WASHER
	20	016800 05000	CLAMPING DISC
	21	537500 10700	VALVE
	28	946917 00000	STUD
	29	917107 00000	CUP SPRING
	30	947105 00000	HEX.NUT
	32	951228 02000	LOCKING SCREW
	36	068101 40500	FLANGES
	37	945634 00000	THREADED PIN
	38	741310 60000	RUBBER BUFFER
	44	867800 99559	FLOAT
	45	005001 40300	SIEVE
	47	727503 99628	BLOW-OFF VALVE
	58	965414 00000	OIL SEPARATING ELEMENT (1x) ²⁾
	59	016802 40300	CLAMPING DISC
	60	921500 50000	HANDLE
63	003700 40500	COVER	
66	945320 00000	SOCKET HEAD SCREW	
67	953103 00000	NOZZLE	
72	005000 40500	METAL FILTER	
74	945321 00000	SOCKET HEAD SCREW	
82	960200 40500	COOLER	
83	917800 40500	RETAINING RING	
84	960700 40500	VENTILATOR HOOD	
85	946308 00000	CYLINDER SCREW	
86	948750 00000	BLIND RIVET	
89	912317 00000	CONNECTING SCREW	
90	948407 00000	HOLLOW SCREW	
94	012203 40500	PIPE	
95	012204 40500	PIPE	
97	068100 40300	SUPPORT PILLAR	
98	741310 80000	RUBBER BUFFER	
99	945218 00000	HEX. HEAD SCREW	
101	002401 40500	HOUSING FOR OIL SEPARATOR	
103	907309 00000	OIL SIGHT GLASS	
105	951219 00000	LOCKING SCREW	
107	951221 00000	LOCKING SCREW	

Index	Pos.	Ident No.	Description 
U 4.40	110	916800 10000	COVER
	114	912318 00000	CONNECTING SCREW
	115	003300 10700	NOZZLE
	116	912300 00000	CONNECTING SCREW
	118	009400 19000	HOLLOW HOLDING SCREW
	119	012200 40300	PIPE
	197	741103 99682	OIL LEVEL CONTROL - OPTIONAL
	201	007801 40500	SCREWED FLANGE - STANDARD
	202	007802 40500	SCREWED FLANGE 90° - OPTIONAL
	203	537506 99633	NON RETURN VALVE
	205	947701 00000	KEY

¹⁾ Set of seals - 549000 40500

- Pos.: 11, 12, 25, 26, 33, 42, 55, 62, 65, 73, 91, 104, 106, 108, 117, 147, 208

²⁾ necessary order quantity / maintenance

OPTIONAL	U4.40	/09	Special design - with gas ballast valve
		/0-25	Special design - with oil-to-water heat exchanger
		/0-56	
<div style="border: 1px solid black; padding: 5px; display: inline-block;"> Items different from standard appliance see appendix (back of drawing) </div> 			

Index	Pos.	No. Identification	Designation 
U 4.40	...	549000 40500	JEU DE JOINTS ¹⁾
	4	500101 40500	CARCASSE
	6	020000 40500	PISTON
	7	900585 00003	PALETTES (KIT)
	8	000700 40500	COUVERCLE
	9	945618 00000	GOUPILLE FILETEE
	14	945373 00000	VIS HEXAGONALE INTERNE
	15	945374 00000	VIS HEXAGONALE INTERNE
	16	947628 01000	GOUPILLE CYLINDRIQUE
	17	945801 01000	GOUPILLE FILETEE
	18	901807 00000	VIS
	19	949203 00000	DENT DISQUE
	20	016800 05000	DISQUE DE SERRAGE
	21	537500 10700	SOUPAPE
	28	946917 00000	PRISONNIER
	29	917107 00000	RESSORT BELLEVILLE
	30	947105 00000	ECROU A 6 PANS
	32	951228 02000	BOUCHON
	36	068101 40500	BRIDES
	37	945634 00000	GOUPILLE FILETEE
	38	741310 60000	AMORTISSEUR EN CAOUTCHOUC
	44	867800 99559	PIED CAOUTCHOVE
	45	005001 40300	FILTRE
	47	727503 99628	SILENCIEUX
	58	965414 00000	ELEMENT SEPARATION HUILE (1x) ²⁾
	59	016802 40300	DISQUE DE SERRAGE
	60	921500 50000	POIGNEE
	63	003700 40500	COUVERCLE
66	945320 00000	VIS HEXAGONALE INTERNE	
67	953103 00000	BUSE	
72	005000 40500	FILTRE EN METAL	
74	945321 00000	VIS HEXAGONALE INTERNE	
82	960200 40500	REFROIDISSEUR	
83	917800 40500	BAGUE DE MAINTIENT	
84	960700 40500	CARTER DE VENTILATEUR	
85	946308 00000	TETE A VIS CYLINDRIQUE	
86	948750 00000	RIVET AVEUGLIE	
89	912317 00000	VIS DE RACCORD	
90	948407 00000	VIS CREUSE	
94	012203 40500	TUYAU	
95	012204 40500	TUYAU	
97	068100 40300	SUPPORT INTERMEDIAIRE	
98	741310 80000	AMORTISSEUR EN CAOUTCHOUC	
99	945218 00000	VIS HEXAGONALE	
101	002401 40500	CORP DE SEPARATEUR D'HUILE	
103	907309 00000	VERRE REGARD	
105	951219 00000	BOUCHON	
107	951221 00000	BOUCHON	

Index	Pos.	No. Identification	Designation 
U 4.40	110	916800 10000	COUVERCLE
	114	912318 00000	VIS DE RACCORD
	115	003300 10700	GICLEUR
	116	912300 00000	VIS DE RACCORD
	118	009400 19000	VIS CREUSE DE FIXATION
	119	012200 40300	TUYAU
	197	741103 99682	INDICATEUR DE NIVEAU - EN OPTION
	201	007801 40500	BRIDE FILETEE - STANDARD
	202	007802 40500	BRIDE FILETEE 90° - EN OPTION
	203	537506 99633	SOUPAPE ANTI-RETOUR
	205	947701 00000	CLAVETTE

¹⁾ Jeu de joints - 549000 40500

- Pos.: 11, 12, 25, 26, 33, 42, 55, 62, 65, 73, 91, 104, 106, 108, 117, 147, 208

²⁾ quantité nécessaire / entretien

EN OPTION

U4.40	/09	Fabrication spéciale - avec l'este d'air
	/0-25	Fabrication spéciale - avec réfrigérant à l'huile et à l'eau
	/0-56	

Articles divergents vis-à-vis de l'appareil standard, voir annexe (dos du dessin / du plan) 

Index	Pos.	No. Identificazione	Designazione 
U 4.40	...	549000 40500	KIT GUARNIZIONI ¹⁾
	4	500101 40500	CARCASSA
	6	020000 40500	ROTORE
	7	900585 00003	PALETTE (KIT)
	8	000700 40500	COPERCHIO
	9	945618 00000	SPINA FILETTATURA
	14	945373 00000	VITE ESAGONALE INTERNA
	15	945374 00000	VITE ESAGONALE INTERNA
	16	947628 01000	PERNO
	17	945801 01000	SPINA FILETTOTA
	18	901807 00000	VITE
	19	949203 00000	DISCO A DENTE
	20	016800 05000	DISCO DI FISSAGGIO
	21	537500 10700	VALVOLA
	28	946917 00000	L'ASTA A VITE
	29	917107 00000	MOLLA A DISCO
	30	947105 00000	DADO ESAGONALE
	32	951228 02000	VITE DI CHIUSURA
	36	068101 40500	FLANGE
	37	945634 00000	SPINA FILETTATURA
	38	741310 60000	AMMORTIZZATORE IN GOMMA
	44	867800 99559	GALLEGGIANTE
	45	005001 40300	FILTRO
	47	727503 99628	SILENZIATORE
	58	965414 00000	CARTUCCIA SEPARATORE OLIO (1x) ²⁾
	59	016802 40300	DISCO DI FISSAGGIO
	60	921500 50000	MANETTA
	63	003700 40500	COPERCHIO
66	945320 00000	VITE ESAGONALE INTERNA	
67	953103 00000	UGGELLO	
72	005000 40500	FILTRO METALLICO	
74	945321 00000	VITE ESAGONALE INTERNA	
82	960200 40500	RAFREDDATORE	
83	917800 40500	ANELLO PORTANTE	
84	960700 40500	CARTER DEL VENTILATORE	
85	946308 00000	VITE A TESTA CILINDRICA	
86	948750 00000	RIVETTO CIECO	
89	912317 00000	ATTACO FILETTATO	
90	948407 00000	VITE ESAGONALE	
94	012203 40500	CONDOTTO	
95	012204 40500	CONDOTTO	
97	068100 40300	SUPPORTO	
98	741310 80000	AMMORTIZZATORE IN GOMMA	
99	945218 00000	VITE ESAGONALE	
101	002401 40500	CARCASSA SEPARAZIONE OLIO	
103	907309 00000	SPIA LIVELLO OLIO	
105	951219 00000	VITE DI CHIUSURA	
107	951221 00000	VITE DI CHIUSURA	

Index	Pos.	No. Identificazione	Designazione 
U 4.40	110	916800 10000	COPERCHIO
	114	912318 00000	ATTACO FILETTATO
	115	003300 10700	UGELLO
	116	912300 00000	ATTACO FILETTATO
	118	009400 19000	VITE PASSAGGIO OLIO
	119	012200 40300	CONDOTTO
	197	741103 99682	SONDA D'OLIO - OPZIONALE
	201	007801 40500	FILANGIA - GILETTATA
	202	007802 40500	FILANGIA 90° - OPZIONALE
	203	537506 99633	VALVOLA NON RITORNO
	205	947701 00000	CHIAVETTA

¹⁾ Serie di guarnizione - 549000 40500

- Pos.: 11, 12, 25, 26, 33, 42, 55, 62, 65, 73, 91, 104, 106, 108, 117, 147, 208

²⁾ quantità di ordinazione necessari / manutenzione

OPZIONALE

U4.40	/09	Modello speciale - con valvola di zavoratrice
	/0-25 /0-56	Modello speciale - con radiatore ad olio - acqua

Vedere allegato (retro del disegno) per le posizioni divergenti dall'apparecchio standard 

Index	Pos.	No. De pedido	Descripción	
U 4.40	...	549000 40500	JUEGO DE JUNTA ¹⁾	
	4	500101 40500	CARCASA	
	6	020000 40500	ÉMBOLO	
	7	900585 00003	EMPUJADOR (KIT)	
	8	000700 40500	TAPA LATERAL	
	9	945618 00000	VARILLA ROSCADA	
	14	945373 00000	TORNILLO HEXAGONAL INTERIOR	
	15	945374 00000	TORNILLO HEXAGONAL INTERIOR	
	16	947628 01000	PASADOR CILÍNDRICO	
	17	945801 01000	VARILLA ROSCADA	
	18	901807 00000	TORNILLO TERMINAL DE ÁRBOL	
	19	949203 00000	POLEA DENTADA	
	20	016800 05000	ARANDELA TENSORA	
	21	537500 10700	VÁLVULA COMPLETA	
	28	946917 00000	ESPÁRRAGO	
	29	917107 00000	MUELLE DE DISCO	
	30	947105 00000	TUERCA HEXAGONAL	
	32	951228 02000	TORNILLO DE CIERRE	
	36	068101 40500	APOYO	
	37	945634 00000	VARILLA ROSCADA	
	38	741310 60000	AMORTIGUADOR DE GOMA	
	44	867800 99559	FLOTADOR	
	45	005001 40300	CRIBA	
	47	727503 99628	VÁLVULA DE BARRIDO	
	58	965414 00000	ELEMENTO DE DESACEITAR DE AIRE (1x) ²⁾	
	59	016802 40300	ARANDELA TENSORA	
	60	921500 50000	EMPUÑADURA	
	63	003700 40500	TAPA	
66	945320 00000	TORNILLO HEXAGONAL INTERIOR		
67	953103 00000	TOBERA DE SILENCIADOR ACÚSTICO		
72	005000 40500	CRIBA		
74	945321 00000	TORNILLO HEXAGONAL INTERIOR		
82	960200 40500	REFRIGERADOR		
83	917800 40500	CHAPA LATERAL		
84	960700 40500	CAPERUZA DE VENTILADOR		
85	946308 00000	TORNILLO CILÍNDRICO		
86	948750 00000	REMACHE CIEGO		
89	912317 00000	TORNILLO DE EMPALME		
90	948407 00000	TORNILLO HUECO		
94	012203 40500	CONDUCTO		
95	012204 40500	CONDUCTO		
97	068100 40300	APOYO		
98	741310 80000	AMORTIGUADOR DE GOMA		
99	945218 00000	TORNILLO HEXAGONAL		
101	002401 40500	CARCASA DE SEPARADOR DE ACEITE		
103	907309 00000	CRISTAL MIRILLA DE ACEITE		
105	951219 00000	TORNILLO DE CIERRE		
107	951221 00000	TORNILLO DE CIERRE		

Index	Pos.	No. De pedido	Descripción	
U 4.40	110	916800 10000	TAPA ROSCADA	
	114	912318 00000	TORNILLO DE EMPALME	
	115	003300 10700	TOBERA	
	116	912300 00000	TORNILLO DE EMPALME	
	118	009400 19000	TORNILLO DE PIEZA ESFÉRICA	
	119	012200 40300	CONDUCTO	
	197	741103 99682	GENERADOR DE NIVEL - OPCIONAL	
	201	007801 40500	BRIDA ROSCADA - STANDARD	
	202	007802 40500	BRIDA ROSCADA 90° - OPCIONAL	
	203	537506 99633	VÁLVULA ANTIRRETORNO	
	205	947701 00000	CHAVETA	

¹⁾ Junta completa - 549000 40500

- Pos.: 11, 12, 25, 26, 33, 42, 55, 62, 65, 73, 91, 104, 106, 108, 117, 147, 208

²⁾ cantidad necesario / mantenimiento

OPCIONAL	U4.40	/09	Versión especial - con valvula de lastre de gas
		/0-25	Versión especial - con refrigerador aceite-agua
		/0-56	
<div style="border: 1px solid black; padding: 5px; display: inline-block;"> Para posiciones que derivan del aparato standard véase apéndice (lado trasero del plano) </div> 			

SERVICE ? i

1~

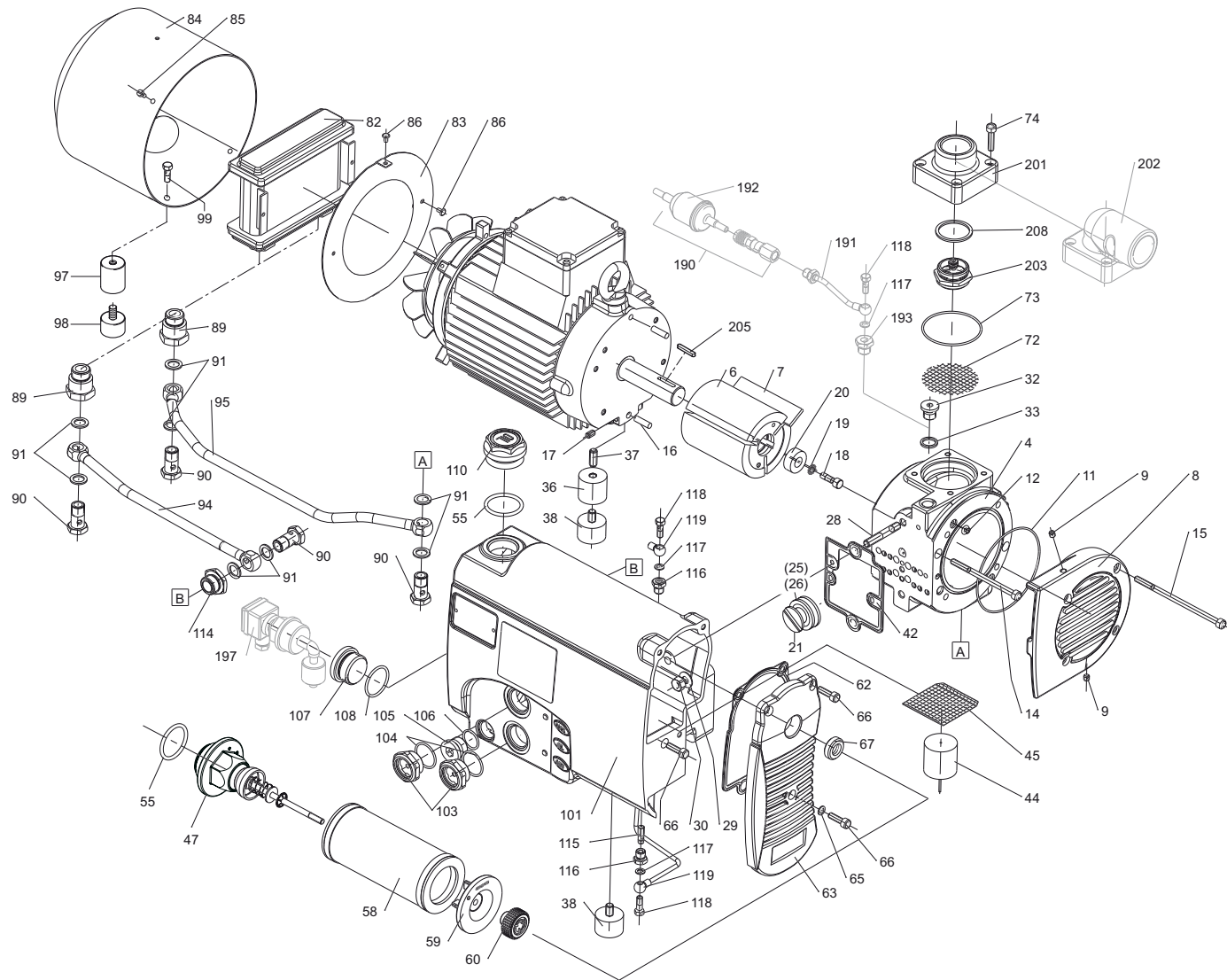

C = ? μ F
U = ? V



standard

U 4.40

optional
en option
opcionale
opcional

optional en option optionale opcional 	Variante(n) Modifications Variantes	Pos ³⁾	Bestell Nr. / Ident No. / No. Identification / No. Identificazione / No. De pedido		Beschreibung / Description / Designation / Designazione / Descripcion
					
U 4.40 / XX	U 4.40 / 09	32		951228-02000	VERSCHLUSS-SCHRAUBE / LOCKING SCREW / BOUCHON / VITE DI CHIUSURA / TORNILLO DE CIERRE
		117	948002 00000		DICHTUNG / GASKET / JOINT / GUARNIZIONE / JUNTA
		118	009400 19000		KUGELSTÜCKSCHRAUBE / HOLLOW HOLDING SCREW / VIS CREUSE DE FIXATION /
		190	568701 99683		VITE PASSAGIO OLIO / TORNILLO DE ESFÉRICA
		191	512000 40500		GASBALLASTVENTIL / GAS BALLAST VALVE / L'ESTE D'AIR / VALVOLA DI ZAVORATRICE /
		193	912304 00000		VÁLVULA DE LASTRE DE GAS
		192	740001 01000		LEITUNG / PIPE / TUYAU / CONDOTTO / CONDUCTO
	U 4.40 / 0-25 U 4.40 / 0-56	82		960200-40500	KÜHLER / COOLER / REFRROIDISSEUR / RAFREDDATORE / REFRIGERADOR
		83		917800-40500	HALTERRING / RETAINING RING / BAGUE DE MAINTIENT / ANELLO PORTANTE / CHAPA LATERAL
		84	460700 40500	960700-40500	LÜFTERHAUBE / VENTILATOR HOOD / CARTER DE VENTILATEUR / CARTER DEL VENTILATORE / CAPE- RUZA DE VENTILADOR
		89		912317-00000	ANSCHLUSS-SCHRAUBE / CONNECTION SCREW / VIS DE RACCORDEMENT / VITE DI RACCORDO / TORNILLO DE EMPALME
		94	012205 40500	012203-40500	LEITUNG / PIPE / TUYAU / CONDOTTO / CONDUCTO
		95	012206 40500	012204-40500	LEITUNG / PIPE / TUYAU / CONDOTTO / CONDUCTO
		97		068100-40300	STÜTZE / SUPPORT PILLAR / SUPPORT INTERMEDIAIRE / SUPPORTO / APOYO
		98		741310-80000	GUMMIPUFFER / RUBBER BUFFER / AMORTISSEUR EN CAOUTCHOUC / AMMORTIZZATORE IN GOMMA / AMORTIGUADOR DE GOMA
		99		945218-00000	SECHSKANTSCHRAUBE / HEX. HEAD SCREW / VIS HEXAGONALE / VITE ESAGONALE / TORNILLO HEXAGONAL
		141	960205 40300		KÜHLER / COOLER / REFRROIDISSEUR / RAFREDDATORE / REFRIGERADOR
		146	948402 00000		HOHLSCHRAUBE / HOLLOW SCREW / VIS CREUSE / VITE ESAGONALE / TORNILLO HUECO
		147	948030 00000		DICHTRING / GASKET / JOINT / GUARNIZIONE / JUNTA

³⁾ variantenabhängige Bauteile / variant-dependent components / composants variante-dependantes / componenti variante-dispendenti / componentes variante-dependientes